

Hilda Street, Leigh, WN7 5DG
Offers Over £170,000

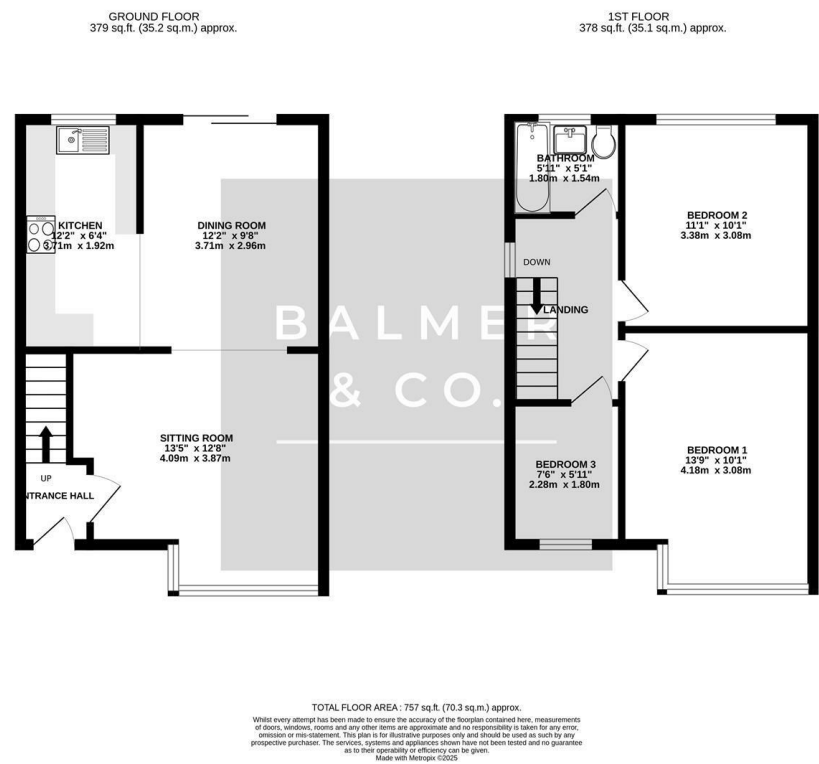

BALMER & CO in LEIGH are delighted to offer FOR SALE this fantastic three bedroom semi-detached house in Leigh. Offered with no onward chain this property comprises in brief of entrance hallway, bay fronted living room, dining room with patio doors leading to the rear garden, with a modern fitted kitchen with integrated appliances completing the ground floor. To the first floor is a large master bedroom with fitted wardrobes, second double bedroom, third single bedroom, with a three piece family bathroom completing the accommodation on offer. Externally the property is garden fronted with a shared driveway to the side, whilst to the rear there is a private, South facing garden with a large garage providing outdoor storage. Early viewings highly recommended, all enquiries welcome.

Floor Plan



Area Map

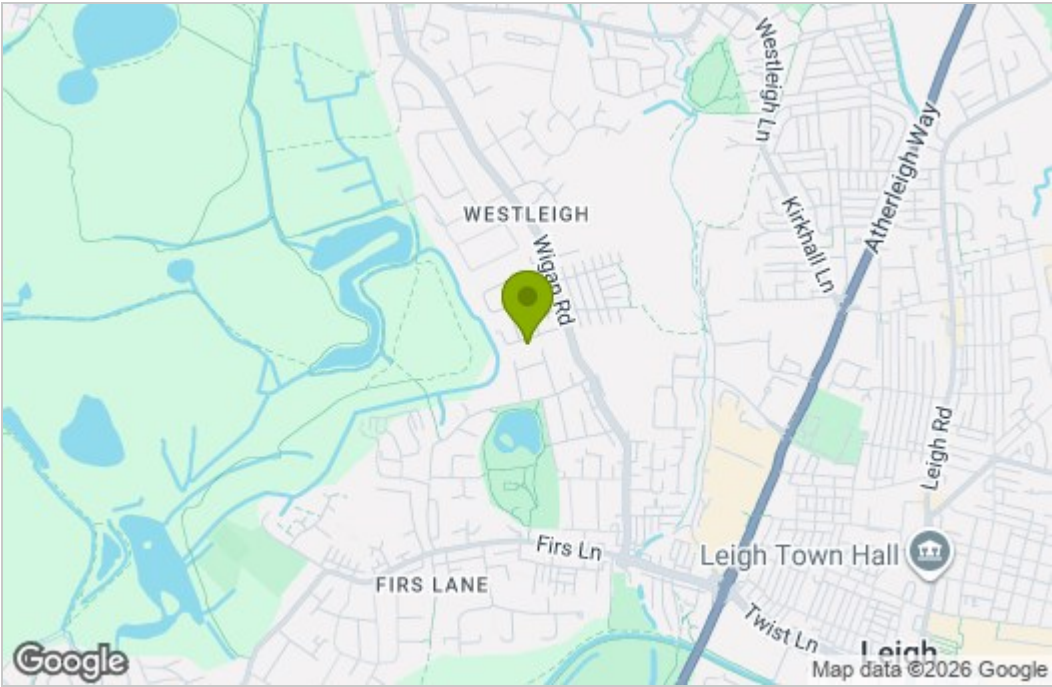

Energy Efficiency Graph

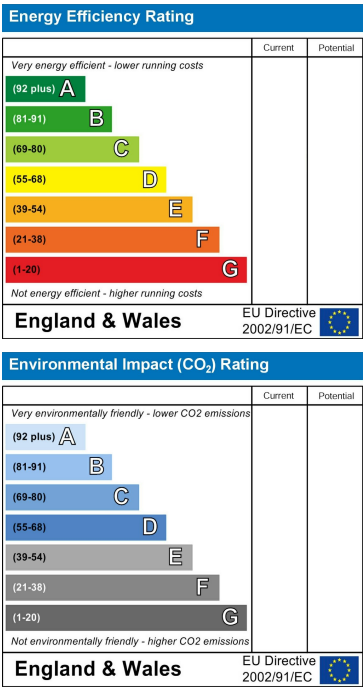

These particulars, whilst believed to be accurate are set out as a general outline only for guidance and do not constitute any part of an offer or contract. Intending purchasers should not rely on them as statements of representation of fact, but must satisfy themselves by inspection or otherwise as to their accuracy. No person in this firms employment has the authority to make or give any representation or warranty in respect of the property.